



Welcome on board!

Install your Jack!

Welcome dear driver!

In order to ensure the smooth running of this collaboration, it is important to follow all steps and user instructions and provide us with feedback on your experience.

In addition, if you have any questions, please contact us at info@smart-jack.com.

What is Jack?

Jack is a telematics device connected to your mobile phone.

Mounted on your windshield, Jack will detect, diagnose and notify in real time any impacts to avoid waiting for the windshield to crack completely and end up being unable to repair it.

If you would like more information about Jack, please visit our website www.smart-jack.com.

We care about your privacy

What Jack does



Detects vibrations while you drive



Translates them into signals



Filters the irrelevant impacts



Notifies you if a potential breaking impact was detected



You drive safely



You repair your windshield



The notification is sent to your fleet manager and/or insurer



What Jack does not do



Film or record you



Record your location, your speed or any other time related data



Store any personal data other than your name and phone number

1

Install the Jack mobile app on your mobile phone

⚠ Be sure to follow this step before installing Jack on your windshield

1. Download the Jack app

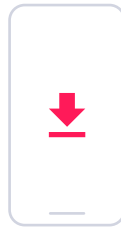

For Android /iPhone, download the Jack app from the Play Store/ App Store by searching for "Jack AGC".

The application only consumes a maximum of 2 MB of data per month.

2. Launch the app on your phone and follow the instructions

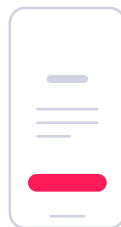

Launch.



Allow "Always" location and notifications.

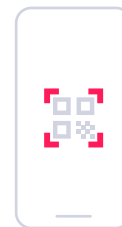

Scan the Jack sensor QR code¹ and your chassis number².



Enter your contact information³.



Accept the general terms and conditions.



Well done, you're all set!

¹ Bottom left of the device

² Bottom right of your windshield

³ These data are collected to be able to notify you in case of impact or to collect feedback.

Install the Jack telematics on your windshield

1. Remove the 3 protective stickers located on the back of the Jack and on the two circular sensors.

- A. Basis tape: must be sure that it is in contact with the glass around the sensor
- B. Sensor tape: must be in contact with the glass
- C. Sensor

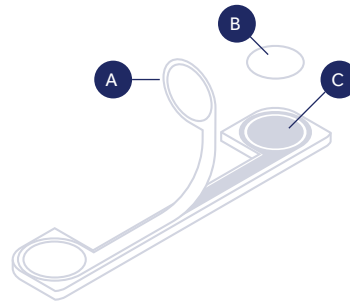

2. Install the device.

⚠ Be sure the area is clean and dry. Clean the area with a cleaning swipe

- A. Apply the basis at the correct location (see hereunder) and press on it for at least 30 seconds (thumb on the sensor area and pressure on the middle)
- B. Slide the main box on the basis

⚠ Please be advised that once the base and the device are together, Jack is considered active and will be charged.

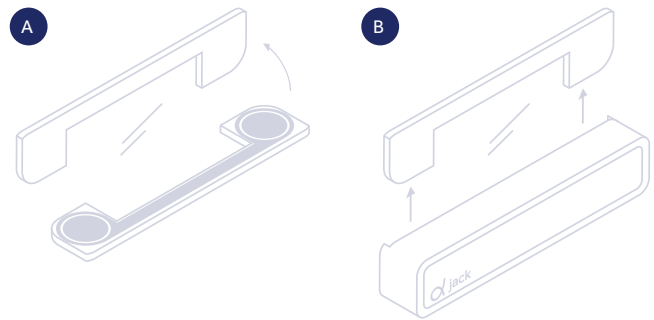

Correct location:

- Inside the vehicle
- On the upper part of the windshield
- Between mirror and sun visor
- NOT on the black area of the windshield

